

## Installing PCs® Corbels

### Identification of the product

PCs® Corbels are available in different models (PCs®, PCs® UP, and PCs® LOCK) and different sizes (2, 3, 5, 7, 10, and 15). The models and sizes can be identified by the name on the product's label; the sizes may be also identified according to the product's color. The color codes are shown in the table below.

### At the precast factory – before casting

The column part is installed in the mold according to the design plans of the column together with the column's reinforcement.

The column part is fixed so that it does not move during casting. There is a thin plate on the column part to protect the teeth and plastic caps to protect the inner threads. The plastic caps can be removed to bolt the column part through the mold (for instance when using wooden and glass fiber molds where holes in mold might need to be fixed after casting). The column part can also be fixed onto the main reinforcement of the column so that it is not able to move during casting.



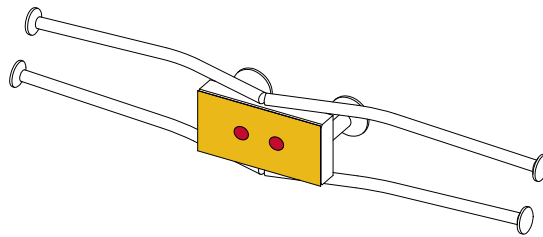



The inner threads must be protected against cement mortar. Supplementary reinforcement must be placed at the area of the column part according to the design plans of the column.



### At the precast factory – after casting

The thin plate that covers the teeth is removed after casting and the teeth should be cleaned if necessary.



	Color		Bolt thread	Bolt length [mm]	 [mm]	Torque [Nm]
PCs 2		Red	M16	100	24	40
PCs 3		Gray	M24	120	36	130
PCs 5		Yellow	M30	145	46	220
PCs 7		Green	M30	145	46	220
PCs 10		Blue	M30	150	46	220
PCs 15		Black	M30	155	46	220

## INSTALLING

The teeth of the column part and corbel part must be checked: they must be undamaged before installing the corbel parts. The corbel parts are installed according to the design plans of the column using bolts so that the rounded surface will be towards the top of the column, the teeth will be tightly interlocked, and the heads of the bolts are tight against the washers.

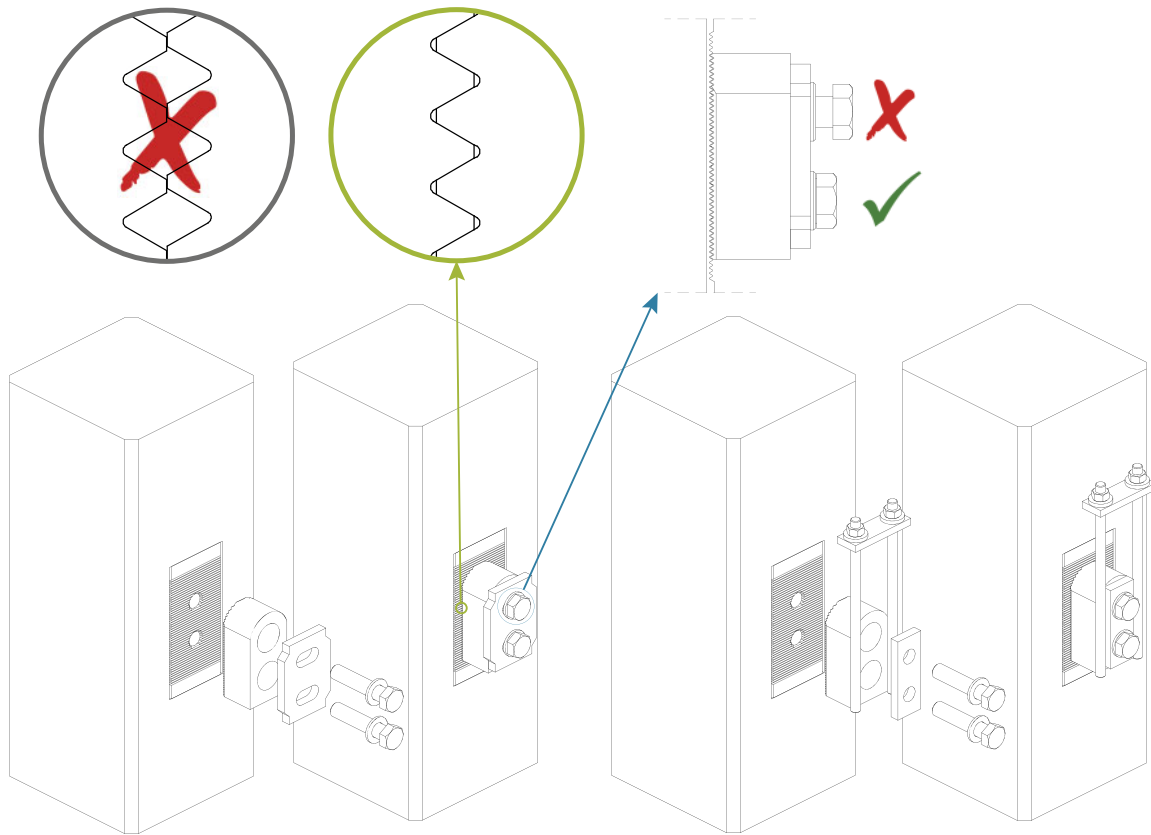

The bolts are tightened according to the torque presented in the table.

### On the construction site

Visual inspections must be carried out before installing the beam to ensure that the corbel parts are installed such that the teeth are tightly interlocked, and the heads of the bolts fit tightly against the washers. This is an important step in guaranteeing the resistance of the corbel.

It is possible to move the corbel parts on-site by untightening the bolts. If this is done, the bolts must be subsequently retightened, the teeth must be tightly interlocked, and the heads of the bolts must fit tightly against the washers.

The beams are installed and supported according to the installation and supporting plans. The corbel will be located in the slot at the end of the beam and the end plate of the beam will be on the corbel plate.

The nuts and washer on the vertical threaded bars in LOCK models must be taken away before installing the beam and placed back immediately after installing the beam.

The joint between the column and the beam is casted at the same time as the joints of slabs.