

Installation of PSB PLUS®

INSTALLING THE PRODUCT – CONSTRUCTION SITE

Horizontal PSH studs and vertical PSB® studs are installed according to project drawing at building site. Each PSH and PSB® element is identified by a code that is printed on a sticker as the assembly profile.

The method of installation of PSB PLUS® to slab depends on the installation of PSB® double headed studs. For PSB®, two types of installation can be used:

- A) Top installation of PSB®
- B) Bottom installation of PSB®

Top installation

Bottom bending reinforcement is placed to clean surface of formwork (A1). Spacers will secure proper concrete cover for bending reinforcement. Bottom layer of PSH horizontal studs are placed directly on bottom bending reinforcement in cruciform layout above the column (A2). The bottom layer of PSH studs follows the direction of bending reinforcement in stronger direction of slab, the second layer is placed in perpendicular direction (weaker direction of slab) (A3).

Top bending reinforcement is installed (A4). PSB® studs are then placed according to installation drawing to reinforcing mesh from top side of slab (A5 - A6).

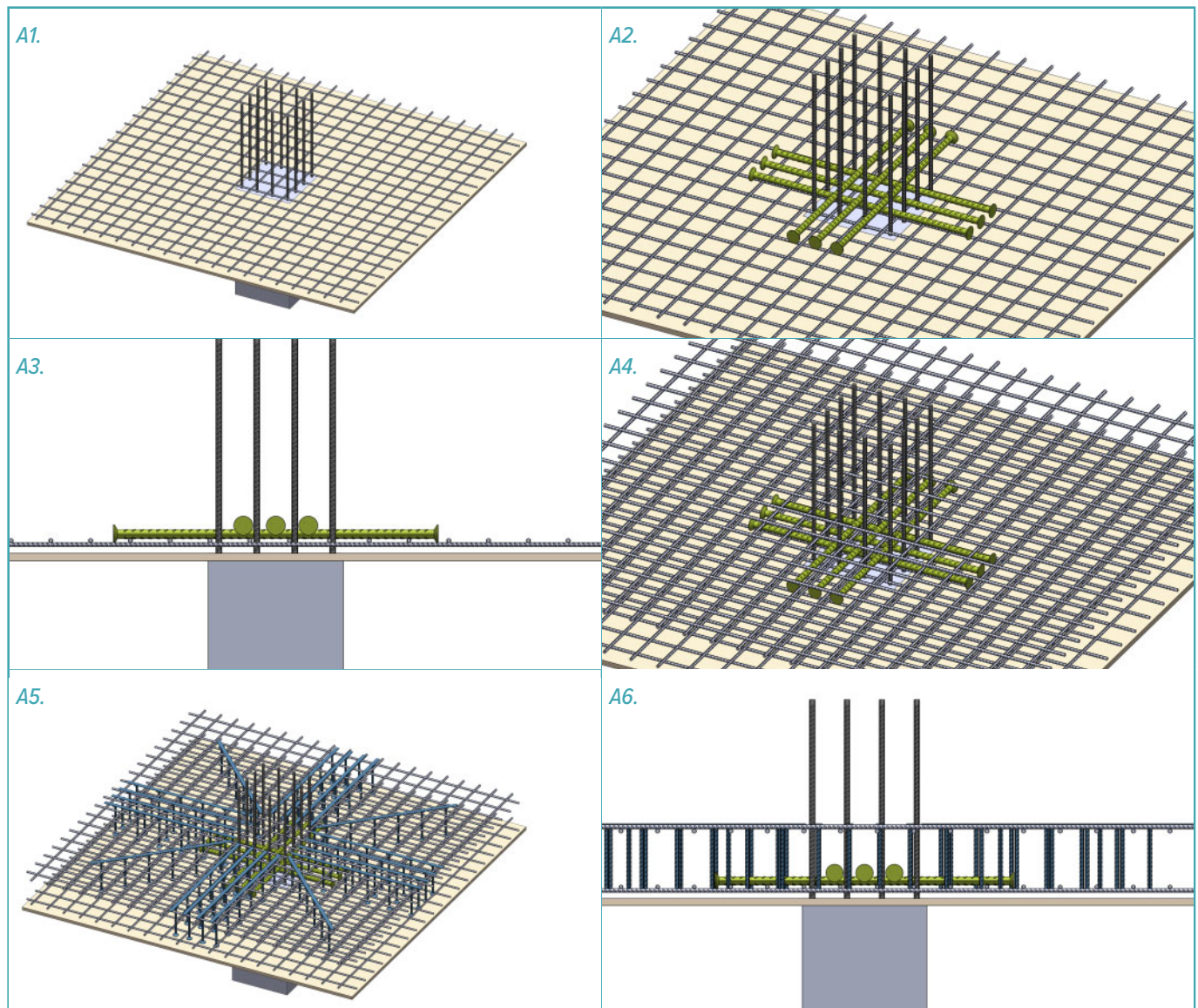

Bottom installation

PSB® studs are placed with spacers on the clean surface of formwork in accordance with installation drawing (B1). The bottom layer of bending reinforcement is installed in both directions (B2). Horizontal PSH studs are placed directly on bottom bending reinforcement right above column (B3). Layers of PSH horizontal studs follow orientation of bending reinforcement (B4). The bottom layout horizontal PSH studs follow direction of bending reinforcement in stronger direction of slab, the second layer is placed in the perpendicular direction.

Top bending reinforcement is installed (B5). It is important to place bending reinforcement and PSH horizontal studs right above each other and to secure proper clear distance rebars for casting of concrete.

